

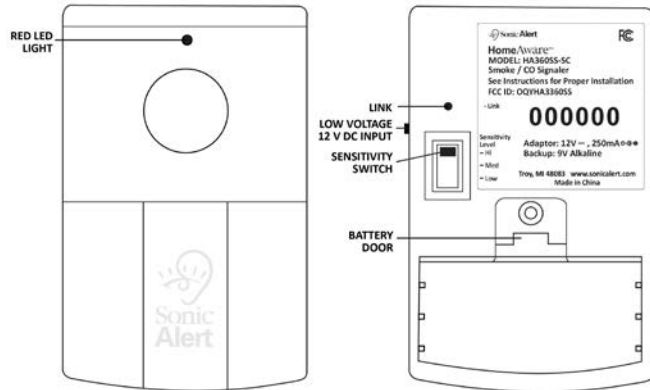

INSTALLATION AND SET UP FOR HOMEWARE™ TRANSMITTER HA360SSSC – Smoke / CO

The HomeAware™ Smoke/CO transmitter will alert you to the sounds produced by the smoke and CO detectors already installed in your home. This transmitter alerts you through the HomeAware™ Main unit and remote receivers located in other rooms.



Battery Backup Installation

Install a new 9 volt alkaline battery into the battery compartment located on the back of the unit. See diagram for battery door location. Battery backup will provide power when a power outage has occurred. Power will be provided for a continuous outage lasting 7 days, or for short outages up to two years.

Link Button Set Up

This procedure will link your transmitter to your Main unit. The Main unit will also provide an alert to all HomeAware™ remote receivers. When using the Bridge unit HA360BU all original Sonic Alert receivers (SA101, SA201, BL300, and SB1000) will also alert you.

It is best to do the link procedure in the same room with the HomeAware™ Main unit, make sure the unit is plugged in.

To link a transmitter to your HomeAware™ Main unit:

1. Press set up button and the word **LINK** will be shown on the display, press Enter. **LINK** will begin blinking. (If **LINK** mode is entered by accident, simply press the **BACK** button to exit and return to the clock.)
2. Press and hold down the Link button on the back of your transmitter for about 1 second. The red LED on the transmitter will light up. Release the button.
3. Upon successful connection, the red LED on the transmitter will flash 2 times, then turn off. The HomeAware™ main unit will briefly show **DONE**, and return to the time display. Your transmitter is now connected and ready to test and use.

Detecting the Different Alert Sounds

This transmitter detects loud sounds and will alert you to the source of that sound.

When a sound is detected from the HA360SSSC it will send a signal to the HomeAware™ base unit and all HomeAware™ remote receivers, also the red LED light will flash on the front of the unit.

If this transmitter detects a loud sound from a smoke detector that meets the T3 standard used for SMOKE DETECTORS, "SMOKE" will scroll on the display of the HomeAware™ Main Unit.

(The T3 standard is on for 0.5 sec, off for 0.5 sec, repeated 3 times, and followed by 1.5 sec of silence, as defined by NFPA code 72.)

If the transmitter detects a loud sound from a CARBON MONOXIDE (CO) DETECTOR that meets the T4 standard, "CO" will scroll on the displayed of the HomeAware™ Main Unit.

(The T4 standard is on for 0.1 sec, off for 0.1 sec, repeated 4 times, and followed by 5 sec silence, as defined by NFPA code 720.)

For All Other Sounds

If a loud sound is detected that does NOT match the T3 or T4 standard, then "ALERT" will scroll on the HomeAware™ Main unit in a loud, repeating pattern.

You can control the sensitivity level for the "ALERT" detection using the switch on the back of the unit. There are three levels to choose from: The HI setting is the most sensitive setting and will alert you to more sounds. Moving this switch to MED makes it less sensitive and will alert you to less sound. The LO setting is the least sensitive. If you're not picking up the sound you need to be alerted to simply move the sensitivity switch to a higher setting. If you have set this setting to HI and you are still not picking up the sound, try moving the transmitter closer to the sound.

Power Input

The HomeAware™ Smoke/CO transmitter uses an included 12V DC power adapter. Plug the power adapter into an 120V AC power outlet, then plug the other end into the Low Voltage 12V DC input on the left side of the unit as show in the diagram.

INSTALLATION AND SET UP FOR HOMEWARE™ TRANSMITTER

HA360SSSC – Smoke / CO

FCC Requirements

This device complies with part 15 of the FCC rules. Operation is subject to the following two conditions; (1) This device might not cause harmful interference, and (2) this device must accept any interference received, including interference that may cause undesired operation.



Note: This equipment has been tested and found to comply with the limits for a Class B digital device, pursuant to part 15 of the FCC rules. These limits are designed to provide responsible protect against harmful interference in a residential installation. This equipment generates, uses, and can radiate radio frequency energy and, if not installed and used in accordance with the instructions manual, may cause harmful interference to radio communications. However, there is no guarantee that interference will not interfere in a particular installation. If this equipment does cause harmful interference to radio or television reception, which can be determined by turning the equipment on and off, the user is encouraged to try to correct the interference by one or more of the following measures:

- i. Reorient or relocate the receiving antenna.
- ii. Increase the separation between the equipment and receiver.
- iii. Connect the equipment into an outlet on a circuit different from that to which the receiver is connected.
- iv. Consult the dealer or an experienced radio /TV technician for help

Modification not expressly approved by the manufacturer could void the user's authority to operate the equipment under FCC rules.

GENERAL DATA

UL listed Power Adaptor: AC100-240V~, 50/60Hz
 Power Consumption: Adaptor Output: DC12V, 250mA

 <p>The Lightning flash and arrowhead within the triangle is a warning sign alerting you of dangerous voltage inside the product.</p>	<p>CAUTION: TO REDUCE THE RISK OF ELECTRICAL SHOCK, DO NOT REMOVE THE COVER (OR BACK) FROM THE PRODUCT. NO USER SERVICEABLE PARTS INSIDE. REFER SERVICING TO YOUR SONIC ALERT DEALER.</p>	 <p>The exclamation mark within the triangle is a warning sign alerting you of important instructions accompanying the product.</p>
--	---	--

WARNING: TO PREVENT FIRE OR SHOCK HAZARD, DO NOT EXPOSE THIS APPLIANCE TO RAIN OR MOISTURE.

The normal function of the product may be disturbed by Strong Electro Magnetic Interference. If so, simply reset the product to resume normal operation by following the instruction manual. In case the function could not resume, please use the product in other location.

- Attention should be drawn to the environmental aspects of battery disposal.
-  This indicating separate collection for electrical and electronic equipment.

SONIC ALERT'S 1 YEAR LIMITED WARRANTY

The HomeAware™ HA360SSSC is warranted against manufacturing defects in materials and workmanship for one (1) year from the date of purchase. Within this period Sonic Alert will repair or replace at our option the HomeAware™ HA360SSSC without charge for parts and labor.

Simply contact our customer service department to obtain an RA (return authorization number) and instructions on how to process your product for return. Call 1-888-864-2446 or e-mail to RMA@sonicalert.info. You'll need a copy of your receipt to process the return authorization.

Sonic Alert Warranty Center
 1081 West Innovation Dr. Kearney, MO 64060, USA.



Made in China
 Sonic Alert, Troy, MI 48083
www.SonicAlert.com 1-888-864-244